

REVISION HISTORY						
ZONE	REV	ECO	DESCRIPTION	BY	DATE	APPROVED
	01		INITIAL RELEASE			

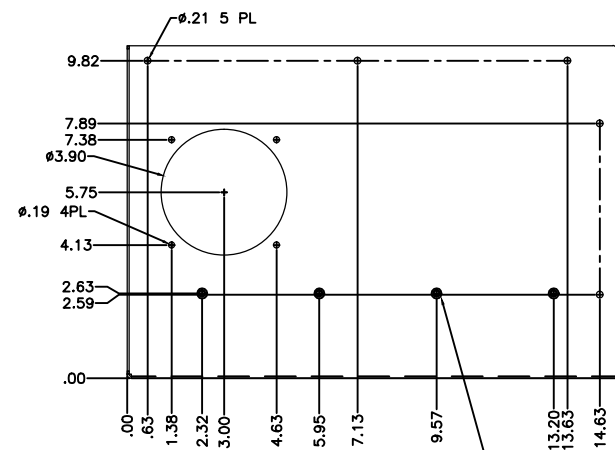
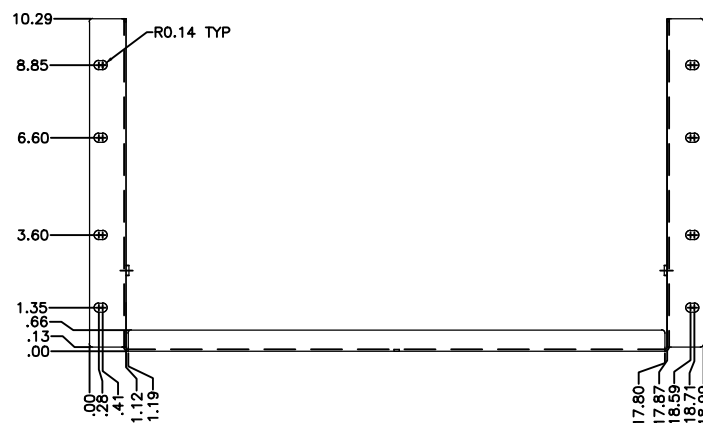
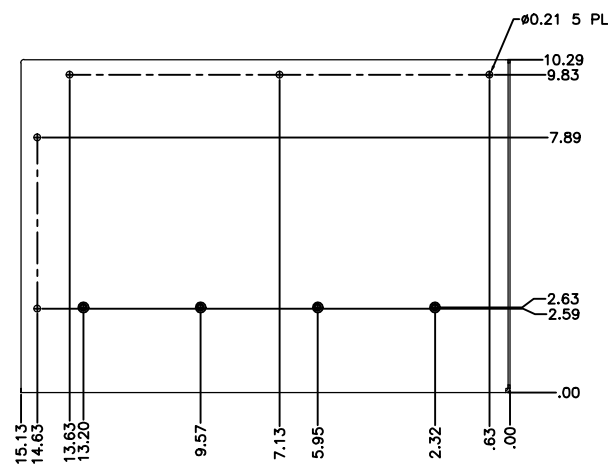
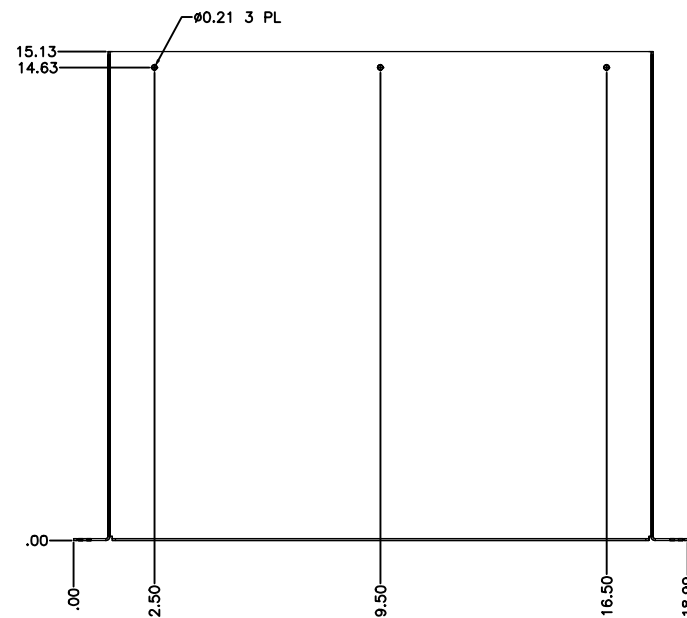

8X #0.213
INSTALL PEM NUTS
FROM FAR SIDE
#CLS-832-2

NOTES:

- UNLESS OTHERWISE SPECIFIED, ALL DIMENSIONS ARE IN INCHES.
- ALL SURFACES MUST BE CLEANED OF ALL GREASE, OIL, AND OTHER CONTAMINANTS AFTER FABRICATION. PREP. FINISHED PART TO AVOID SUBSEQUENT CONTAMINATION FROM HANDLING.
- ALL SURFACES TO BE MACHINED AND/OR FINISHED. UNFINISHED SURFACES ARE NOT ACCEPTABLE.
- MARK (INDELIBLE INK NON-VACUUM PARTS) PART NUMBER/REV. IN CAPITALS, 0.375" HIGH IN APPROX. LOCATION INDICATED BY REF. LEADER.
- FINISH - POWDER COAT DUPONT SKY WHITE PFW-510-S9, TGIC-POLYESTER, GLOSS 85-95%.

UNLESS OTHERWISE SPECIFIED DIMENSIONS ARE IN INCHES. TOLERANCES ARE:		APPROVALS	DATE
DECIMALS .XX ± .01 .XXX ± .005 .XXXX ± .0010	ANGLES ± 1°	DRAWN JD/ADM	30OCT12
MACHINE FINISH 32/		ENG.	
DO NOT SCALE DRAWING INTERPRET DIM AND TOL PER ASME Y14.5M-1994		THIRD ANGLE PROJECTION	
MATERIAL .0478 MILD STEEL		TITLE CHASSIS, MOTION CONTROL, 8U	
FINISH SEE NOTE 5		SIZE C	DWG NO K17218022
REMOVE ALL BURRS AND SHARP EDGES		SCALE NONE	REV 01
		SHEET 1 OF 1	